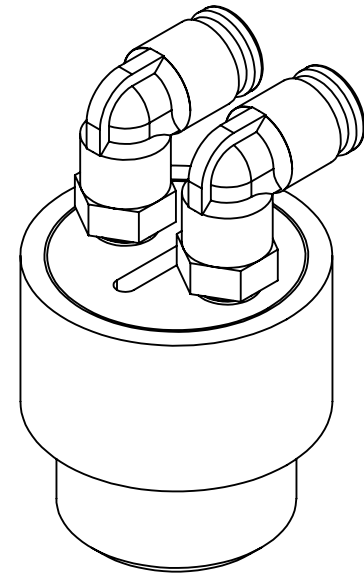
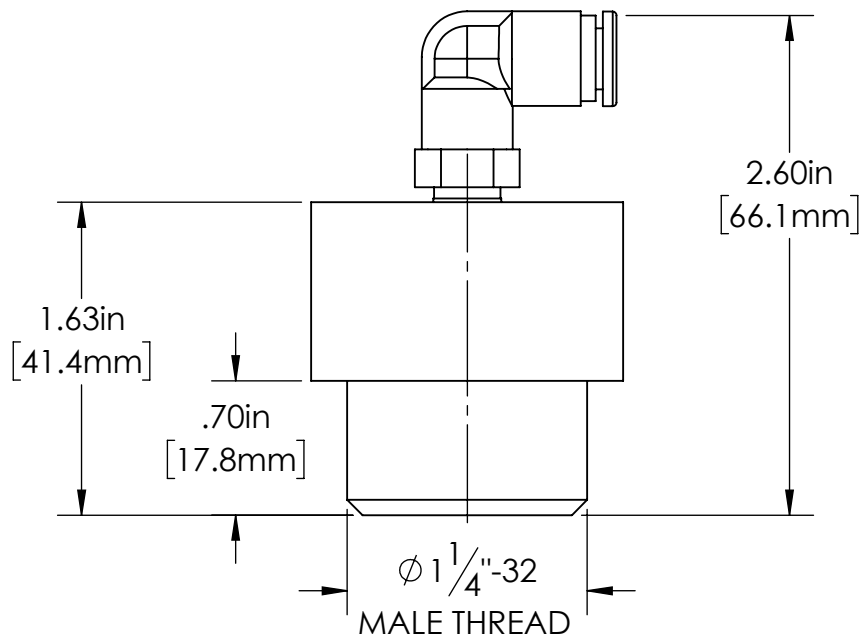
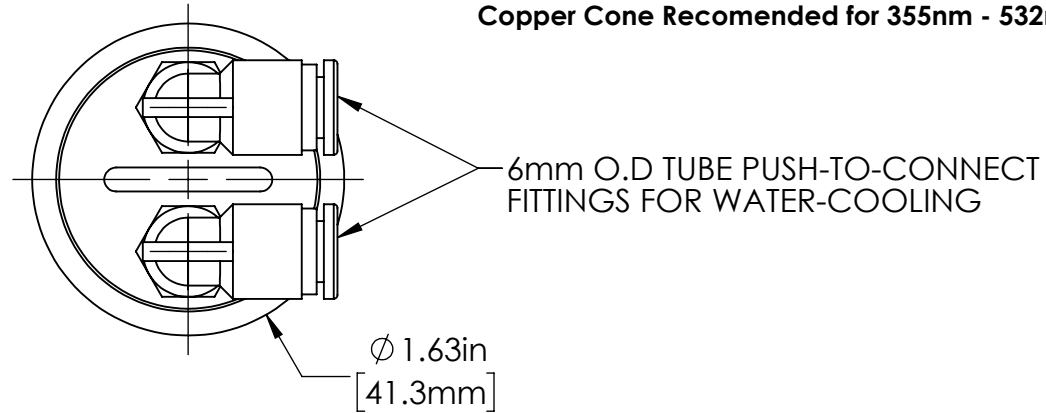

**ORDERING INFO:****BD-25-B-W:** Laser Beam Dump, 25mm Series, Coated Brass cone, Water Cooled**BD-25-C-W:** Laser Beam Dump, 25mm Series, Copper Cone, Water Cooled**Note: Coated Brass Cone Recommended for 1032nm - 10.6 $\mu$ m.****Copper Cone Recommended for 355nm - 532nm**FOR INFORMATION ONLY  
NOT FOR MANUFACTURINGDATE:  
11/14/2016DRAWN BY:  
SGCHK'D BY:  
GJH

HAAS DOC.# BD-25-W-SALES

SPECIFICATIONS SUBJECT TO CHANGE WITHOUT NOTICE.  
CONTACT HAAS LTI FOR MORE INFORMATION.TOLERANCES:  
(EXCEPT AS NOTED)X.XXX =  $\pm 0.005$ X.XX =  $\pm 0.01$ X X/X =  $\pm 1/64$ ANGULAR:  $\pm 0.5^\circ$ 

No.	REVISIONS	DATE	APPD

37 IRONIA ROAD  
FLANDERS NJ 07836  
(973) 598-1150  
Fax: 598-1151BD-25 WATER-COOLED  
BEAM DUMPBOM#  
NA

SCALE: 1:1